

① Ready for data transmission.

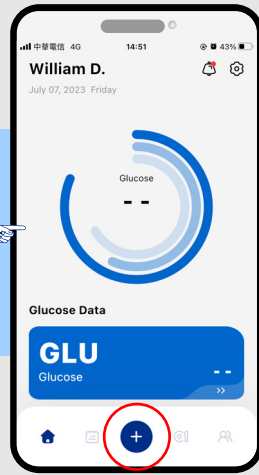

② Open BeneCheck APP and Click the " + " icon to start Bluetooth transmission process.



③ Click " Bluetooth " option.

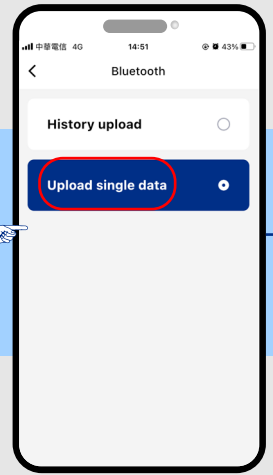

④ Click " Single Data " option.

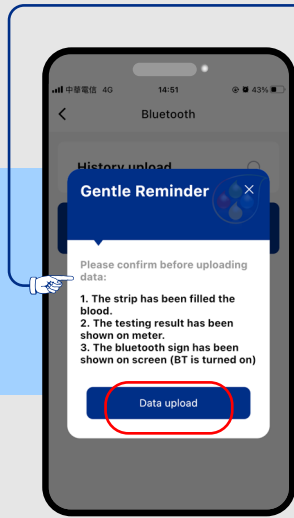

⑤ Check all reminders are completed and then Click " data upload " icon.

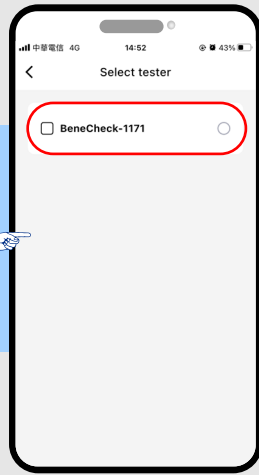

⑥ Search and select your Device ID.

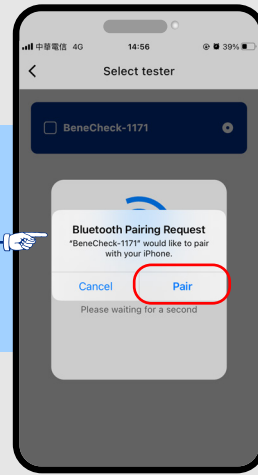

⑦ Pairing device for the first time use.

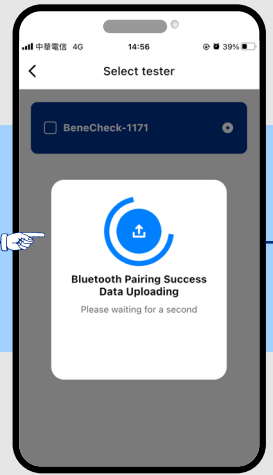

⑧ After pairing is completed, the device will automatically transmit data to APP.

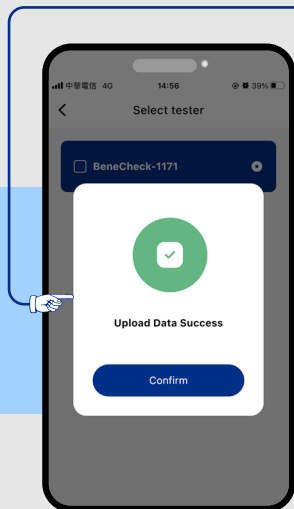

⑨ Complete the transmission and enter the data management page.

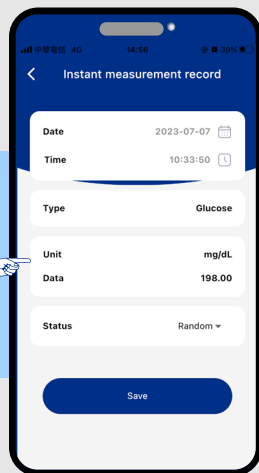

⑩ The management page can modify the meal status. (Only for glucose record).

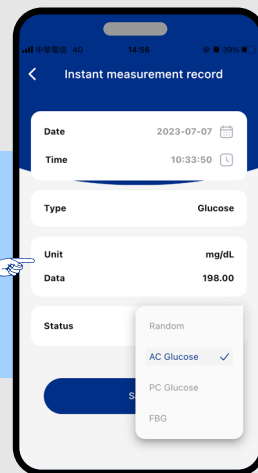

⑪ Save the data and complete the transmission process.

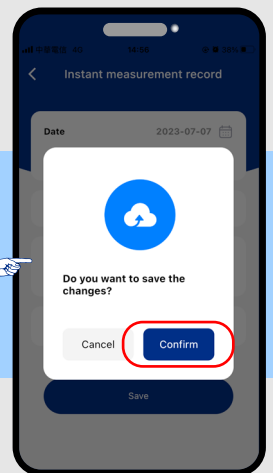

BeneCheck™ Bluetooth historical data upload process

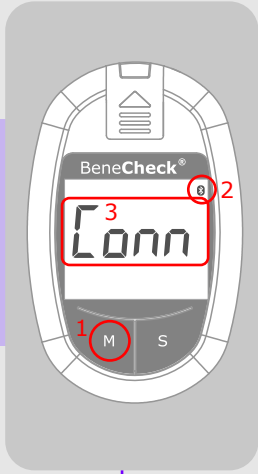

① **In Memory mode:**
When the screen show the "Conn" means ready for data transmission.

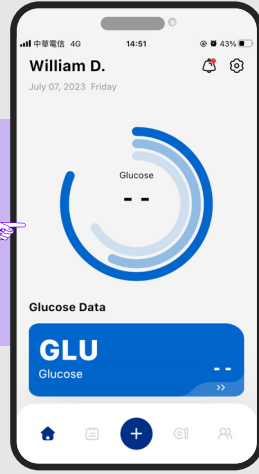

② Open BeneCheck APP.

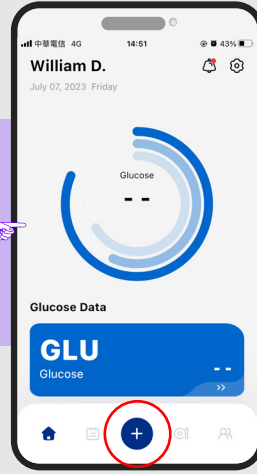

③ Click the "+" icon to start Bluetooth transmission process.

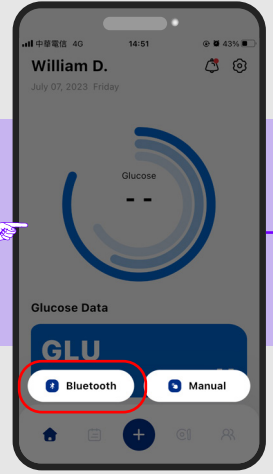

④ Click "Bluetooth" option.

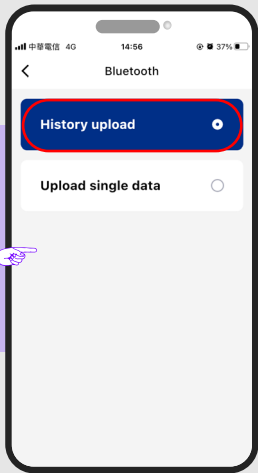

⑤ Click "History upload" option.

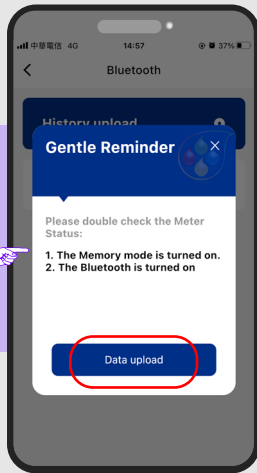

⑥ Check all reminders are completed and then Click "data upload" icon.

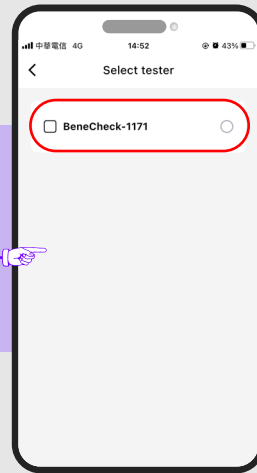

⑦ Search and select your Device ID.

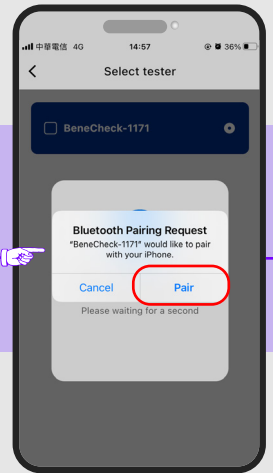

⑧ Pairing device for the first time use.

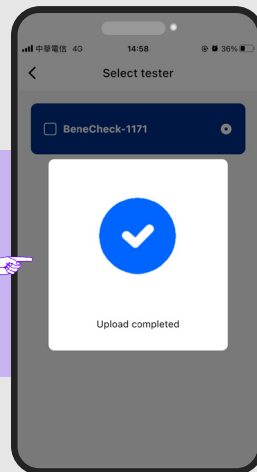
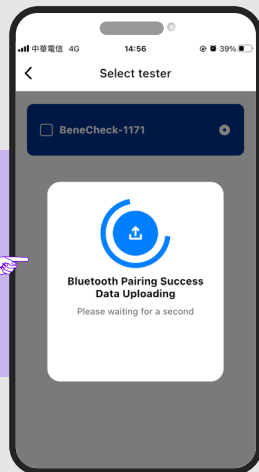

⑨ After pairing is completed, the device will automatically transmit data to APP.

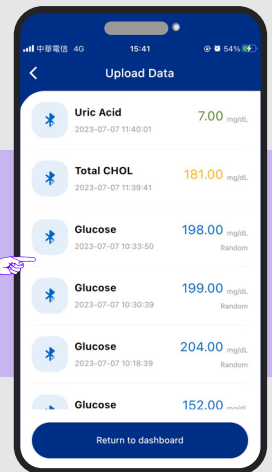

⑩ Complete the transmission and enter the database page.

Download on the App Store

GET IT ON Google Play

